

† NOTE

Jibs with a hook reach of 150 ft (45.7m) and longer require the 75'-3" (22.9m) counterjib. For jibs with a hook reach of 132 ft (40.2m) or shorter, the 62'-2" (18.9m) counterjib must be used.

Consult Morrow Equipment for specific information regarding alternate tower configurations, alternate foundation details, dimensions, reaction forces and slab openings.

BOTTOM CLIMBING with P20 Inner Tower Sections (Inside Structure)

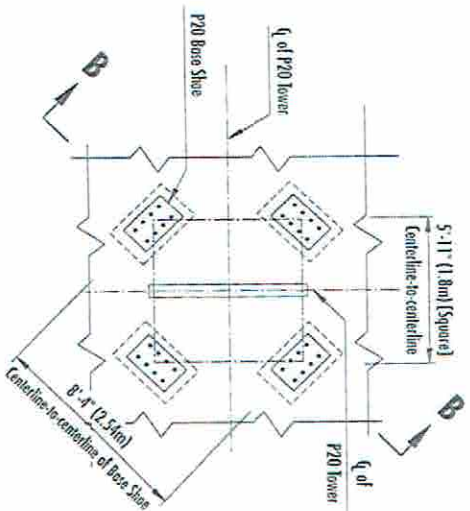
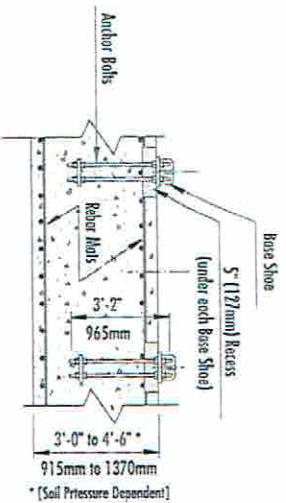

P20 Foundation – Elevation

Section B-B

P20 Foundation – Plan

FOUNDATION DETAILS

with P20 Inner Tower
(Concrete Slab)

Radius and Capacities

Pecco Tower Crane Model PC 2000

2-Part Line

Hook Radius	2-Part Line Max Capacity - Radius	ft	20	30	40	50	60	70	80	90	100	110	115	125	132	140	150	160	168
		m	6.1	9.1	12.2	15.2	18.3	21.3	24.4	27.5	30.5	33.5	35.0	38.1	40.2	42.7	45.7	48.8	51.2
168 ft 51.2m	20,350 lbs - 65 ft 9,230 kg - 19.8m	lbs	20,350	20,350	20,350	20,350	20,350	18,800	16,400	14,200	12,500	11,200	10,700	9,600	8,900	8,200	7,800	6,950	6,400
		kg	9,230	9,230	9,230	9,230	9,230	8,530	7,440	6,440	5,670	5,080	4,850	4,350	4,040	3,720	3,540	3,150	2,900
150 ft 45.7m	20,350 lbs - 70 ft 9,230 kg - 21.3m	lbs	20,350	20,350	20,350	20,350	20,350	20,350	17,750	15,500	13,600	12,100	11,600	10,400	9,750	9,000	8,100		
		kg	9,230	9,230	9,230	9,230	9,230	9,230	8,050	7,030	6,170	5,490	5,260	4,720	4,420	4,080	3,670		
132 ft 40.2m	24,250 lbs - 64 ft 11,000 kg - 19.5m	lbs	24,250	24,250	24,250	24,250	24,250	21,900	18,900	16,500	14,500	12,950	12,200	11,000	10,300				
		kg	11,000	11,000	11,000	11,000	11,000	9,930	8,570	7,480	6,580	5,570	5,530	4,990	4,670				
115 ft 35.0m	24,250 lbs - 67 ft 11,000 kg - 20.4m	lbs	24,250	24,250	24,250	24,250	24,250	23,000	19,900	17,200	15,200	13,750	12,850						
		kg	11,000	11,000	11,000	11,000	11,000	10,430	9,030	7,800	6,890	6,240	5,830						

Capacity

- 22,000 lbs/9,980 kg
- 20,000 lbs/9,070 kg
- 18,000 lbs/8,165 kg
- 16,000 lbs/7,260 kg
- 14,000 lbs/6,350 kg
- 12,000 lbs/5,440 kg
- 10,000 lbs/4,540 kg
- 8,000 lbs/3,630 kg
- 6,000 lbs/2,720 kg
- 4,000 lbs/1,815 kg
- 2,000 lbs/905 kg

